

Dodd-Walls Centre - 10th Annual Symposium 2017 PROGRAMME

Monday 23 January

Tuesday 24 January

Wednesday 25 January

Thursday 26 January

Friday 27 January

<p>Review Sessions: all PIs and AIs invited to attend B</p> <p>8.30 am - 8.45 am Board Chair Welcome</p> <p>8.45 am - 9.15 am Director's Introduction</p> <p>9.15 am - 10.15 am Part One: Science Excellence Theme 1A and Theme 1B</p> <p>10.15 am - 10.45 am Morning Tea H</p>	<p>9.00 am - 10.30 am Industry Panel Deliberations HR</p> <p>9.00 am - 10.30 am Board Meeting TB</p> <p>10.30 am - 11.00 am Morning Tea</p> <p>11.00 am - 12.00 noon Report back from Industry Panel to Board and DWC Members B</p>	<p>8.30 am - 9.30 am Tutorial III - Resonator Harald Schwefel H</p> <p>9.30 am - 10.00 am Morning Tea H</p> <p>10.00-11.00 Tutorial IV - Quantum Information Jevon Longdell H</p>	<p>9.00 am - 9.50 am H Invited Talk Professor Ana Maria Rey Chair: Blair Blakie</p> <p>9.50 am - 10.35 am H Contributed Talks Chair: Blair Blakie</p> <p>9.50 am - 10.05 am Cushla McGoverin 10.05 am - 10.20 am Bianca Sawyer 10.20 am - 10.35 am Ben Mallett</p> <p>10.35 am - 11.05 am H Morning Tea</p> <p>11.05 am - 11.50 am H Contributed Talks Chair: Ashton Bradley</p> <p>11.05 am - 11.20 am Danny Baillie 11.20 am - 11.35 am Thomas Ward 11.35 am - 11.50 am Antonio Munoz</p> <p>11.50 am - 12.20 pm H Maori - Ka Hikitia Session</p> <p>12.20 pm - 12.45 pm H MBIE Grant Writing</p> <p>12.45 pm - 1.30 pm A Lunch</p> <p>Excursion/Free Time</p> <p>Buses depart Otago Museum & University at 6.30 pm</p> <p>7.00 pm - Conference Dinner at Larnach Castle</p>	<p>9.00 am - 9.50 am H Invited Talk Professor Poul Jessen Chair: Niels Kjaergaard</p> <p>9.50 am - 10.35 am H Contributed Talks Chair: Niels Kjaergaard</p> <p>9.50 am - 10.05 am Mike Reid 10.05 am - 10.20 am Lauri Toikka 10.20 am - 10.35 am Nina Novikova</p> <p>10.35 am - 11.05 am H Morning Tea</p> <p>11.05 am - 11.50 am H Contributed Talks Chair: Jevon Longdell</p> <p>11.05 am - 11.20 am Karen Webb 11.20 am - 11.35 am Ruth Cink 11.35 am - 11.50 am Dylan Brown</p> <p>11.50 am - 12.20 pm H Gender & Diversity Session</p> <p>12.20 pm - 12.45 pm H Marsden Grant Writing</p> <p>12.45 pm - 1.30 pm A Lunch</p> <p>1.30 pm to 2.20 pm H Invited Talk Professor Peter Smith Chair: Neil Broderick</p> <p>2.20 pm - 3.20 pm H Contributed Talks Chair: Neil Broderick</p> <p>2.20 pm - 2.35 pm Matt Hunter 2.35 pm - 2.50 pm Soizic Terrien 2.50 pm - 3.05 pm Ryan Thomas</p> <p>3.05 pm - 3.35 pm H Afternoon Tea</p> <p>Theme Photos H 3.30 pm - 4.00 pm</p> <p>3.35 pm - 4.20 pm TB Theme 1A Group Meeting</p> <p>4.20 pm - 5.05 pm TB Theme 1B Group Meeting</p>	<p>9.00 am - 9.50 am H Invited Talk Professor Monika Ritsch-Martel Chair: Harald Schwefel</p> <p>9.50 am - 10.35 am H Contributed Talks Chair: Harald Schwefel</p> <p>9.50 am - 10.05 am Luke Trainor 10.05 am - 10.20 am Yadong Wang 10.20 am - 10.35 am Lewis Williamson</p> <p>10.35 am - 11.05 am H Morning Tea</p> <p>11.05 am - 11.50 am H Contributed Talks Chair: Joachim Brand</p> <p>11.05 am - 11.20 am Kathy Ludge 11.20 am - 11.35 am Rakesh Arul 11.35 am - 11.50 am Sophie Shamailov</p> <p>11.50 am - 12.05 pm H Closing Remarks</p> <p>12.05 pm - 12.35 pm H DWC Membership Session</p> <p>12.45 pm - 1.30 pm A Lunch</p> <p>1.30 pm - 2.15 pm TB Theme 2A Group Meeting</p> <p>2.15 pm - 3.00 pm TB Theme 2B Group Meeting</p>
<p>10.45 am - 11.45 am B Part One: Science Excellence Theme 2A and Theme 2B</p> <p>11.45 am to 12.45 pm Part One: Science Excellence Panel Discussion</p> <p>12.45 pm - 1.30 pm A Lunch</p> <p>1.30 pm - 2.30 pm B Part Two: Industry Engagement and Commercialisation</p> <p>2.30 pm - 4.00 pm HR SAB Deliberations</p> <p>2.30 pm - 4.00 pm TB Board Meeting (ISWG)</p> <p>4.00 pm - 5.00 pm B SAB Report back to Board and Investigators</p> <p>5.10 pm - 5.30 pm HR SAB/Board/IAP Photos</p> <p>7.00 pm - onwards Dinner at Otago Museum (by invitation) Part Three: Educational Outreach</p>	<p>12.00 noon - 1.00 pm A Lunch</p> <p>1.00 pm - 1.30 pm H DWC Symposium Opening</p> <p>1.30 pm - 2.20 pm H Invited Talk Professor Dr Ursula Keller Chair: John Harvey</p> <p>2.20 pm - 3.20 pm H Contributed Talks Chair: John Harvey</p> <p>2.20 pm - 2.35 pm Keith Gordon 2.35 pm - 2.50 pm Jayson Cosme 2.50 pm - 3.05 pm Sam Ruddell 3.05 pm - 3.20 pm Michel Nieuwoudt</p> <p>3.20 pm - 3.50 pm H Afternoon Tea</p> <p>4.00 pm - 4.30 pm H Cather Simpson - Women in Tech</p> <p>4.30 pm - 5.00 pm H 1 Minute - 1 Slide - Poster Presentation Hosted: Harald Schwefel</p> <p>5.00 pm - 5.30 pm H Contributed Talks Chair: Mikkel Andersen</p> <p>5.00 pm - 5.15 pm Ashton Bradley 5.15 pm - 5.30 pm Simon Ashforth</p> <p>6.30 pm - 8.30 pm A Group Photo Poster Session Drinks and nibbles provided</p>	<p>11.05 am - 11.50 am H Contributed Talks Chair: Ashton Bradley</p> <p>11.05 am - 11.20 am Danny Baillie 11.20 am - 11.35 am Thomas Ward 11.35 am - 11.50 am Antonio Munoz</p> <p>11.50 am - 12.20 pm H Maori - Ka Hikitia Session</p> <p>12.20 pm - 12.45 pm H MBIE Grant Writing</p> <p>12.45 pm - 1.30 pm A Lunch</p>	<p>11.05 am - 11.50 am H Contributed Talks Chair: Jevon Longdell</p> <p>11.05 am - 11.20 am Karen Webb 11.20 am - 11.35 am Ruth Cink 11.35 am - 11.50 am Dylan Brown</p> <p>11.50 am - 12.20 pm H Gender & Diversity Session</p> <p>12.20 pm - 12.45 pm H Marsden Grant Writing</p> <p>12.45 pm - 1.30 pm A Lunch</p>	<p>11.05 am - 11.50 am H Contributed Talks Chair: Joachim Brand</p> <p>11.05 am - 11.20 am Kathy Ludge 11.20 am - 11.35 am Rakesh Arul 11.35 am - 11.50 am Sophie Shamailov</p> <p>11.50 am - 12.05 pm H Closing Remarks</p> <p>12.05 pm - 12.35 pm H DWC Membership Session</p> <p>12.45 pm - 1.30 pm A Lunch</p>	

Attendance

Review Part 1 & 2: Board, SAB, Industry Panel, all PI's & AI's welcome to attend
Board and Advisory meetings: Board/panel members only
DWC Tutorials: all symposium attendees welcome to attend
Symposium: Invited Speakers: all symposium attendees welcome to attend
Symposium: Contributed talks: all symposium attendees welcome to attend
Symposium: Poster presentations: all symposium attendees welcome to attend
DWC special sessions: all DWC members expected to attend, symposium attendees also welcome
DWC Membership and Theme sessions: DWC only, all DWC members expected to attend

Room Key

Hutton Lecture Theatre. Ground Floor
Annex (Postmaster Gallery)
Barclay Theatre, First Floor
Huia Room, Ground Floor
Theomin Balcony (upstairs in Annex)



Room Locations



GROUND LEVEL

- i* INFO DESK
- WC** TOILETS
- WHEELCHAIR ACCESSIBLE TOILET
- BABY CHANGING FACILITY
- LIFT
- CLOAKROOM
- 1** HUTTON THEATRE
- 2** KĀKĀPŌ ROOM
- 3** HUIA ROOM
- 4** SIR EDMUND HILLARY COLLECTION



DOWNSTAIRS ANNEX

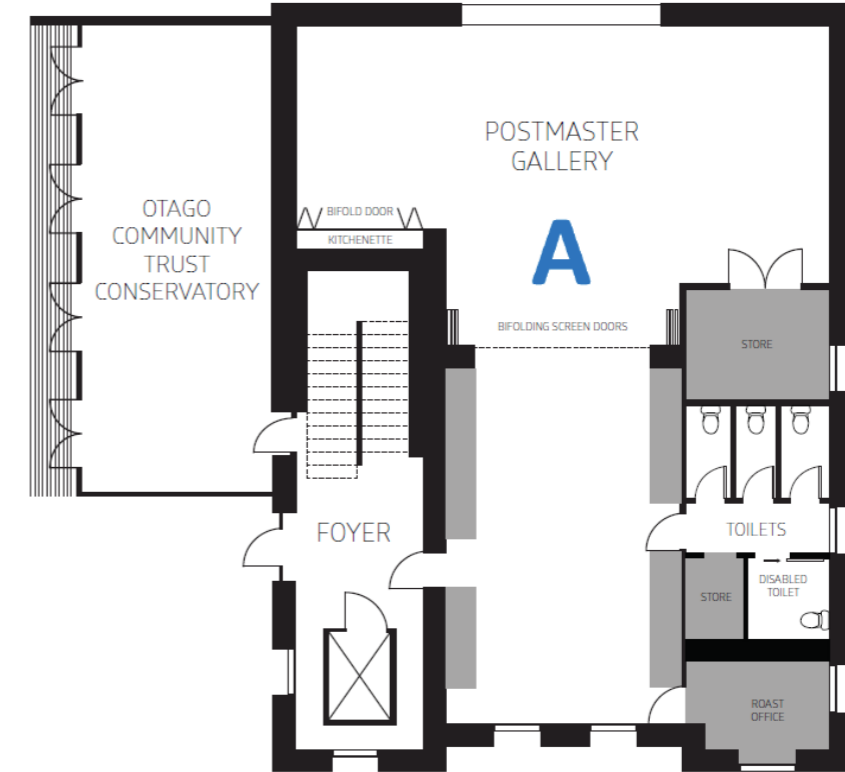

LEVEL 1

- WC** TOILETS
- WHEELCHAIR ACCESSIBLE TOILET
- BABY CHANGING FACILITY
- LIFT
- 4** SIR EDMUND HILLARY COLLECTION
- 5** BARCLAY THEATRE
- 6** SPECIAL EXHIBITIONS GALLERY
- 7** PACIFIC CULTURES
- 8** TĀNGATA WHENUA
- 9** 1877 GALLERY
- 10** SEARCH CENTRE
- 11** DISCOVERY WORLD
- 12** TROPICAL FOREST
- 13** BEAUTIFUL SCIENCE GALLERY
- 14** PERPETUAL GUARDIAN PLANETARIUM
- *** DISCOVERY DESK

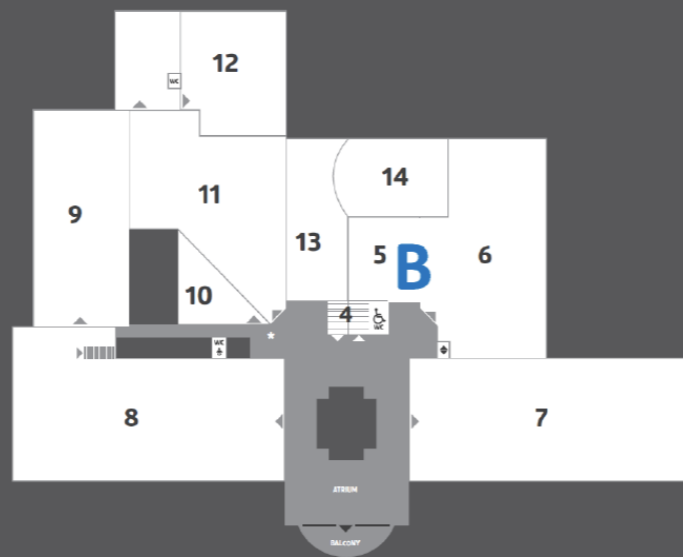

UPSTAIRS ANNEX

